

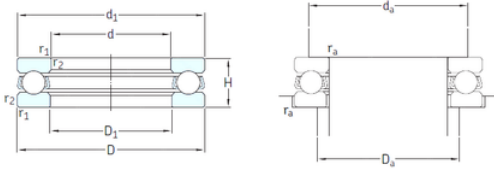

# PFG BEARING LIMITED

## skf 51102 bearing

Bearing No. 51102



51102 Bearing 2D drawings and 3D CAD models

Size	15x28x9 mm
Bore Diameter	15 mm
Outer Diameter	28 mm
Width	9 mm
d	15 mm
D	28 mm
H	9 mm
d1	28 mm
r1 min.	0,3 mm
r2 min.	0,3 mm
D1	16 mm
da min.	23 mm
Da max.	20 mm
ra max.	0,3 mm
Weight	0,023 Kg
Basic dynamic load rating (C)	10,6 kN
Basic static load rating (C0)	18,3 kN
Fatigue load limit (Pu)	0,67
Reference speed	8500 r/min
Limiting speed	12000 r/min
Category	Thrust Ball Bearing
Inventory	0.0
Manufacturer Name	SKF
Minimum Buy Quantity	N/A
Weight / Kilogram	0.028
EAN	7316577058409



## PFG BEARING LIMITED

Product Group	B00308
Rolling Element	Ball Bearing
Thrust Bearing	Yes
Single or Double Direction	Single Direction
Banded	No
Cage Material	Steel
Precision Class	ABEC 1   ISO P0
Component Description	Roller Assembly Plus Raceways
Other Features	Single Row
Long Description	15MM Bore 1; 16MM Bore 2; 28MM Outside Diameter; 9MM Height; Ball Bearing; Single Direction; Not Banded; Steel Cage; ABEC 1   ISO P0 Precision
Inch - Metric	Metric
Category	Thrust Ball Bearings
UNSPSC	31171507
Harmonized Tariff Code	8482.10.50.08
Noun	Bearing
Keyword String	Ball Thrust
Manufacturer URL	<a href="http://www.skf.com">http://www.skf.com</a>
Manufacturer Item Number	51102
Weight / LBS	0.062
Bore 2	0.63 Inch   16 Millimeter
Overall Height with Aligning Washer	0 Inch   0 Millimeter
Outside Diameter	1.102 Inch   28 Millimeter
Bore 1	0.591 Inch   15 Millimeter
Height	0.354 Inch   9 Millimeter
bore diameter:	15 mm
static load capacity:	18.3 kN
outside diameter:	28 mm



## PFG BEARING LIMITED

dynamic load capacity:	10.6 kN
overall width:	9 mm
maximum rpm:	12000 RPM
thrust bearing type:	Single-Direction
cage material:	Steel
outside diameter design:	Straight
fillet radius:	0.3 mm
separable or banded:	Separable
series:	511
precision rating:	ABEC 1 (ISO Class Normal)
$d_1$	28 mm
$D_1$	16 mm
$r_{1,2}$ min.	0.3 mm
$d_a$ min.	23 mm
$D_a$ max.	20 mm
$r_a$ max.	0.3 mm
Basic dynamic load rating C	10.6 kN
Basic static load rating $C_0$	18.3 kN
Fatigue load limit $P_u$	0.67 kN
Minimum load factor A	0.0017
Mass bearing (including seat washer where applicable)	0.023 kg