

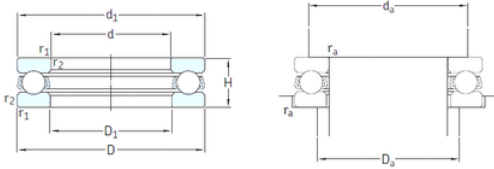

PFG BEARING LIMITED

skf 51204 bearing



Bearing No. 51204

51204 Bearing 2D drawings and 3D CAD models

Size	20x40x14 mm
Bore Diameter	20 mm
Outer Diameter	40 mm
Width	14 mm
d	20 mm
D	40 mm
H	14 mm
d1	40 mm
r1 min.	0,6 mm
r2 min.	0,6 mm
D1	22 mm
da min.	32 mm
Da max.	28 mm
ra max.	0,6 mm
Weight	0,083 Kg
Basic dynamic load rating (C)	21,2 kN
Basic static load rating (C0)	37,5 kN
Fatigue load limit (Pu)	1,4
Reference speed	6000 r/min
Limiting speed	8000 r/min
Category	Thrust Ball Bearing
Inventory	0.0
Manufacturer Name	SKF
Minimum Buy Quantity	N/A
Weight / Kilogram	0.085
EAN	7316577058539



PFG BEARING LIMITED

Product Group	B00308
Rolling Element	Ball Bearing
Thrust Bearing	Yes
Single or Double Direction	Single Direction
Banded	No
Cage Material	Steel
Precision Class	ABEC 1 ISO P0
Component Description	Roller Assembly Plus Raceways
Other Features	Single Row
Long Description	20MM Bore 1; 22MM Bore 2; 40MM Outside Diameter; 14MM Height; Ball Bearing; Single Direction; Not Banded; Steel Cage; ABEC 1 ISO P0 Precision
Inch - Metric	Metric
Category	Thrust Ball Bearings
UNSPSC	31171507
Harmonized Tariff Code	8482.10.50.08
Noun	Bearing
Keyword String	Ball Thrust
Manufacturer URL	http://www.skf.com
Manufacturer Item Number	51204
Weight / LBS	0.187
Bore 2	0.866 Inch 22 Millimeter
Outside Diameter	1.575 Inch 40 Millimeter
Overall Height with Aligning Washer	0 Inch 0 Millimeter
Bore 1	0.787 Inch 20 Millimeter
Height	0.551 Inch 14 Millimeter
bore diameter:	20 mm
static load capacity:	37.5 kN
outside diameter:	40 mm



PFG BEARING LIMITED

dynamic load capacity:	21.2 kN
overall width:	14 mm
maximum rpm:	8000 RPM
thrust bearing type:	Single-Direction
cage material:	Steel
outside diameter design:	Straight
fillet radius:	0.6 mm
separable or banded:	Separable
series:	512
precision rating:	ABEC 1 (ISO Class Normal)
d_1	40 mm
D_1	22 mm
$r_{1,2}$ min.	0.6 mm
d_a min.	32 mm
D_a max.	28 mm
r_a max.	0.6 mm
Basic dynamic load rating C	21.2 kN
Basic static load rating C_0	37.5 kN
Fatigue load limit P_u	1.4 kN
Minimum load factor A	0.0085
Mass bearing (including seat washer where applicable)	0.083 kg