

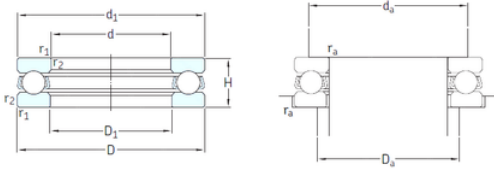

PFG BEARING LIMITED

skf 51111 bearing

Bearing No. 51111



51111 Bearing 2D drawings and 3D CAD models

Size	55x78x16 mm
Bore Diameter	55 mm
Outer Diameter	78 mm
Width	16 mm
d	55 mm
D	78 mm
H	16 mm
d1	78 mm
r1 min.	0,6 mm
r2 min.	0,6 mm
D1	57 mm
da min.	69 mm
Da max.	64 mm
ra max.	0,6 mm
Weight	0,23 Kg
Basic dynamic load rating (C)	30,2 kN
Basic static load rating (C0)	81,5 kN
Fatigue load limit (Pu)	3
Reference speed	3800 r/min
Limiting speed	5300 r/min
Category	Thrust Ball Bearing
Inventory	0.0
Manufacturer Name	SKF
Minimum Buy Quantity	N/A
Weight / Kilogram	0.232
EAN	7316576677434



PFG BEARING LIMITED

Product Group	B00308
Rolling Element	Ball Bearing
Thrust Bearing	Yes
Single or Double Direction	Single Direction
Banded	No
Cage Material	Steel
Precision Class	ABEC 1 ISO P0
Component Description	Roller Assembly Plus Raceways
Other Features	Single Row
Long Description	55MM Bore 1; 57MM Bore 2; 78MM Outside Diameter; 16MM Height; Ball Bearing; Single Direction; Not Banded; Steel Cage; ABEC 1 ISO P0 Precision
Inch - Metric	Metric
Category	Thrust Ball Bearings
UNSPSC	31171507
Harmonized Tariff Code	8482.10.50.08
Noun	Bearing
Keyword String	Ball Thrust
Manufacturer URL	http://www.skf.com
Manufacturer Item Number	51111
Weight / LBS	0.512
Overall Height with Aligning Washer	0 Inch 0 Millimeter
Bore 1	2.165 Inch 55 Millimeter
Bore 2	2.244 Inch 57 Millimeter
Height	0.63 Inch 16 Millimeter
Outside Diameter	3.071 Inch 78 Millimeter
bore diameter:	55 mm
static load capacity:	81.5 kN
outside diameter:	78 mm



PFG BEARING LIMITED

dynamic load capacity:	30.2 kN
overall width:	16 mm
maximum rpm:	5300 RPM
thrust bearing type:	Single-Direction
cage material:	Steel
outside diameter design:	Straight
fillet radius:	0.6 mm
separable or banded:	Separable
series:	511
precision rating:	ABEC 1 (ISO Class Normal)
d_1	78 mm
D_1	57 mm
$r_{1,2}$ min.	0.6 mm
d_a min.	69 mm
D_a max.	64 mm
r_a max.	0.6 mm
Basic dynamic load rating C	30.2 kN
Basic static load rating C_0	81.5 kN
Fatigue load limit P_u	3 kN
Minimum load factor A	0.039
Mass bearing (including seat washer where applicable)	0.23 kg